



USB Game Pack Key Installation Guide

The UltraCade™ Multi-Game System USB Game Pack Key requires no unlock code to install on your system. Please be aware that once you install the USB Game Pack Key on an UltraCade Multi-Game System, the USB Game Pack Key will lock itself to that system. This prevents the USB Game Pack Key from being used on multiple systems.

Step A: Verify Software Version Number

1. Press the Service button located behind the coin door to access the Operator menu.
2. The software version number is displayed on the Operator Main Menu, as shown below. If the version number is less than 3.84, you must update the software before you can install the USB Game Pack.
 - If the version number is 3.84 or greater, skip to *Step B: Check the USB Cable*.
 - If the version number is lower than 3.84, contact Tech Support at 408.597.3435 to request an updated Ultracade Multi-Game System Installation CD.



Step B: Check the USB Cable

Your new Game Pack comes with a USB extension cable that will make it easier to install this and future USB Game Pack Keys. If you have already installed a USB extension cable into your cabinet, skip to *Step D: Install the Game(s)*.

1. Plug the male end of the USB cable into an open USB port on the system computer. There are different types of computers used to run the UltraCade Multi-Game System, and the arrows in *Step C1*, below, show the location of the USB port on each type of computer. **Do not** unplug any other USB cable connected to the computer, as this is used by the USBlinx™ I/O card.
2. Run the cable through the cabinet to the front where it can be accessed through the coin door opening. Attach the female end of the cable to the metal plate using the pre-attached Velcro®.

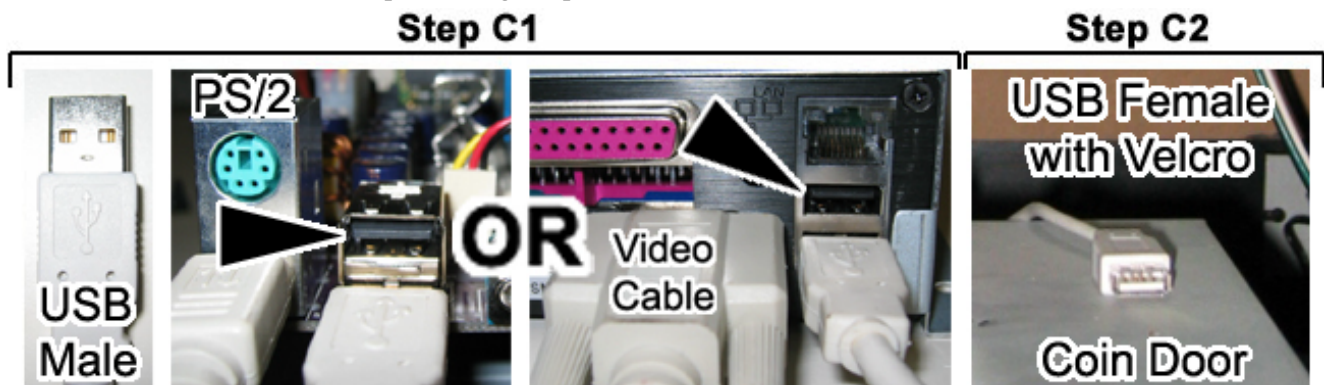

Step D: Install the Game(s)

Follow the steps below to install the new games on your system:

1. Make sure your cabinet is powered ON and running the attract mode. Plug the USB Game Pack Key into the female end of the USB extension cable inside the Coin Door.
2. The system will automatically detect the USB Game Pack Key and begin to copy the games to the hard drive.
3. Once the installation is complete, remove the Game Pack Key and place it in a safe place. Your new games are installed and ready to play!



www.globalvr.com
<http://service.globalvr.com>
techsupport@globalvr.com
Phone: 408.597.3435
Fax: 408.597.3437